



62 Ah Space Cell



Lithium-Ion Secondary Cell

Features and Benefits

- Qualified for space flight
- Prismatic cell design
- Fully-welded, hermetically-sealed construction
- Compression seals
- 175 ±20 psi rupture disk vent
- High energy density
- Highly reliable
- Low cyclic capacity fade
- Long life
- Stainless steel case and cover

Applications

- Low-earth orbit (LEO) satellite missions
- Mid-earth orbit (MEO) satellite missions
- Geosynchronous-earth orbit (GEO) satellite missions
- Scientific and exploratory satellite missions
- Launch vehicles

High energy level lithium-ion at a low weight and small volume

Specifications

Part Number	SLC-16050-003
Weight	2.02 kg (4.45 lbs)
Dimensions (less terminal)	Height: 173 mm (6.80 in.) Width: 82 mm (3.21 in.) Depth: 58 mm (2.30 in.)
Beginning of Life Capacity	62.5 Ah, 245 Wh at 20°C (68°F) EOCV 4.1 CC/CV, C/2 Discharge
Nameplate Capacity	52 Ah, 204 Wh at 20°C (68°F) EOCV 4.1 CC/CV, C/2 Discharge
Charge Current Limit	31.25 A to 4.1 EOCV CC/CV
Discharge Current Limit	62.5 A to 3.0 EODV
Pulse Current Limit	12 A for 10 second
Energy Density	305.4 Wh/L
Specific Energy	121.3 Wh/kg
Operating Temperature	10 to 30°C (50 to 86°F)
Storage Temperature	-5 to 5°C (23 to 41°F)
Vibration Limit	Random 24.7 g
Transportation ¹	Class 9 ID number - UN3090

¹ For complete transportation regulations, contact EaglePicher Technologies

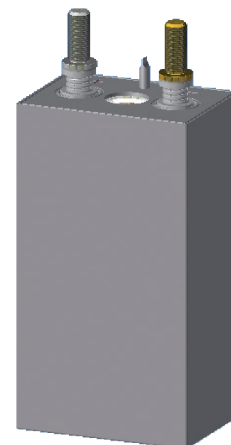

62Ah Space Cell

