



## SAP-12307 Thermal Battery



Case and header 304 stainless steel, terminal nickel iron alloy hot soldered

### Specifications

Part Number	SAP-12307
Weight	294.8 g (0.65 lbs)
Nominal Volume	20.8 in <sup>3</sup>
Dimensions	Width: 38 mm (1.5 in)
	Length: 74 mm (2.9 in)
Voltage Range	Maximum: 16 VDC
	Minimum: 9.5 VDC
Load	40 W base load with a 7 A max, 0.020 duration pulse @ 60 sec
Rise Time	0.5 sec
Life	270 sec
Activation	Shock
Activation Indicator	Temperature decal
Operating Temperature	-45.0 to 62.8°C (-45 to 145°F)
Acceleration	Not applicable
Vibration	Axial 2.45 g
	Radial 2.83 g
Shock	1100 g 15 ms activation
Spin	30 Hz, 3 sec; 10 Hz, 20 sec; 0 Hz to Life
Terminal Material	52 nickel iron alloy hot smoldered

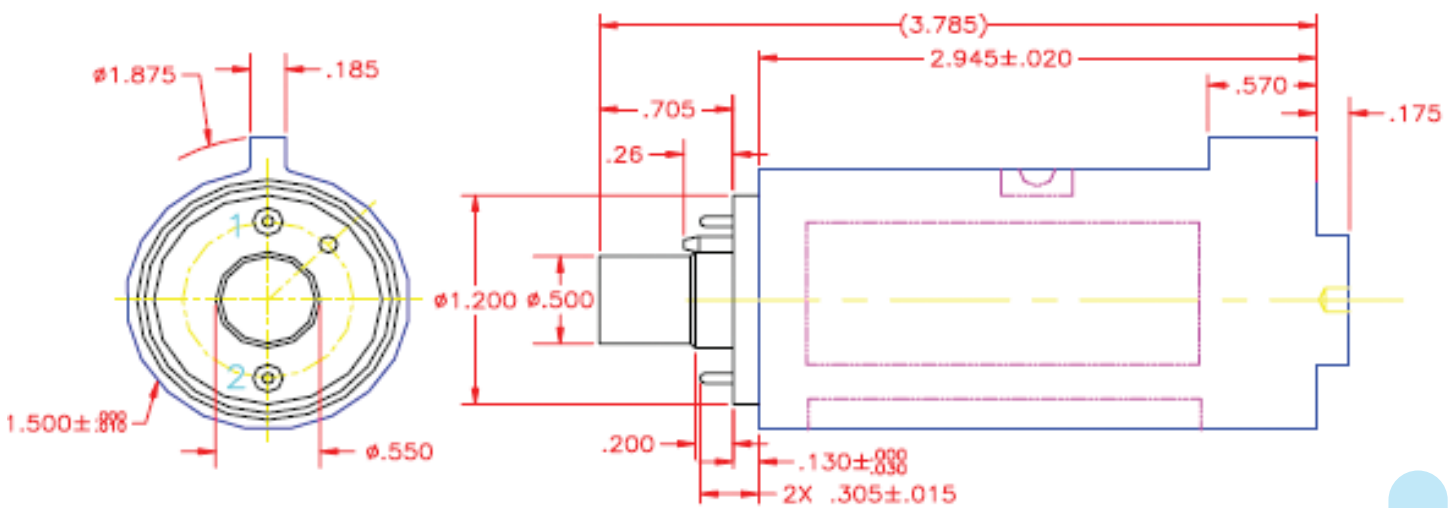

# SAP-12307 Thermal Battery

TYPICAL PERFORMANCE:      RISE TIME: (COLD: 0.06 SEC. TO 9.5 Vdc; HOT: 0.010 SEC. TO 9.5 Vdc)

