

3.0 V Primary D Cell



Non-rechargeable Li/CFx-MnO₂ Hybrid

**Highly reliable,
lightweight cell with
impressive rate
capability over a wide
operating temperature
range**

Features and Benefits

- Double the capacity of Li-SO₂D cells
- 1.4 times the capacity of Li-MnO₂ D cells
- Wide operating temperature range
- Excellent rate capability
- Fully-welded, hermetically-sealed construction
- Pressure release vent, shutdown separator and thermal fused for safety
- Negative case polarity
- Wide range of mission applications
- Easily configured for any custom battery assembly

Applications

- Soldier power: C4ISR, silent watch
- Unattended ground sensors
- Survival and emergency equipment
- GPS/mobile assist devices
- Alarming devices
- Automatic meter reading
- Oil and gas monitoring and metering
- Emergency lighting
- Personnel/border sensors

Specifications

Part Number	LCF-15004
Weight	97 g (3.4 oz)
Height	61.0 mm (2.4 in.)
Diameter	33.1 mm (1.3 in.)
Nominal Voltage	2.6 V ¹
Voltage Range	2.0-3.3 V
Capacity	16 Ah ¹
Specific Energy	402 Wh/kg
Energy Density	743 Wh/L
Maximum Continuous Current	3.0 A ² To avoid overheating. Higher currents possible
Maximum Pulse Current	6.0 A Voltage performance will vary according to pulse characteristics, temperature and the cell history.
Operating Temperature	-40 to +60°C (-40 to 140°F)
Storage Temperature	-40° to +71°C (-40 to 160°F)
Exterior	Nickel-plated mild steel
Terminals/Connector	Based upon customer preference
Transportation	Class 9 I- U.S. and International ³
<small>¹ Based on 2 A discharge at 21°C (70°F)</small>	
<small>² Depends on combination of rate, temperature, thermal management and other application factors</small>	
<small>³ For complete transportation regulations, contact EaglePicher Technologies</small>	

Concept Design - Product Under Development

3.0 V Primary D Cell

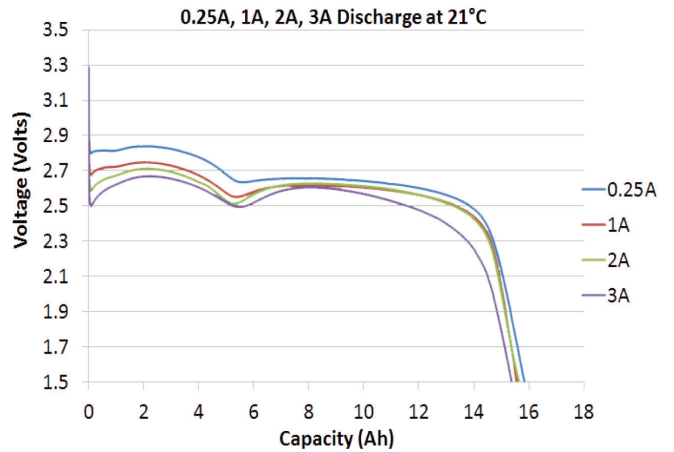
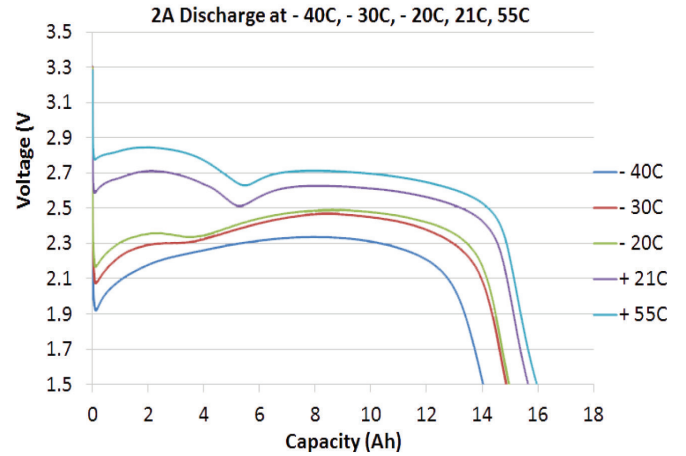
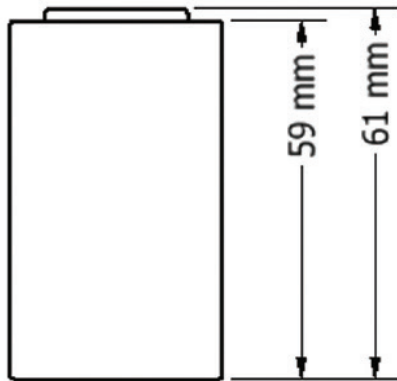
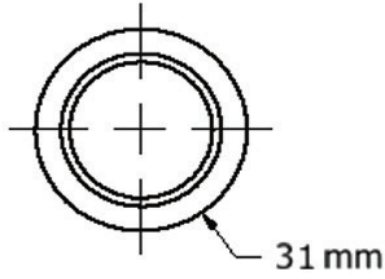

Concept Design - Product Under Development