

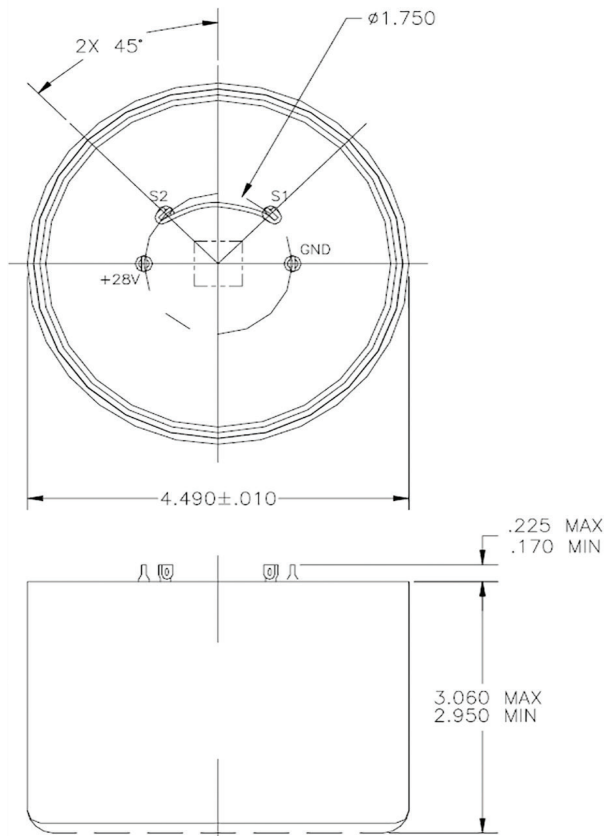

EAP-12312 Thermal Battery



Thermal battery: lithium silicon/iron disulfide (LiSi/FeS₂)



Specifications

Part Number	EAP-12312
Weight	2042 g (4.5 lbs)
Nominal Volume	49.7 in ³
Dimensions	Width: 114 mm (4.49 in)
	Length: 83 mm (3.28 in)
Case and Header Material	Type 304 stainless steel
Terminal Material	52 iron nickel alloy (Fe/Ni) hot soldered
Voltage Range	35 VDC max
	24 VDC min
Load	2.5 A base load from 0-35 sec
	4.5 A base load from 35-600 sec
	6.0 A base load from 600-1035 sec
	4.5 A base load from 1035 sec to end voltage of 24 VDC
	21.5 A, 500 ms applied at 4.1 sec followed by 5.5 A, 3.5 sec load
	Ten 25.0 A, 50 ms pulses applied every second starting at 134.95 sec and ending at 1034.95 sec
Rise Time	1.75 sec
Life	1035 sec
Activation	EP-250-14
Activation Indicator	Temperature decal
Operating Temperature	-40 to 71°C (-40 to 160°F)
Vibration	Longitudinal 2.75 Grms
	Vertical & lateral 3.88 Grms
Shock	Longitudinal 40 g peak at 2000 Hz
	Vertical & lateral 300 g peak at 2000 Hz

EAP-12312 Thermal Battery

TYPICAL PERFORMANCE: RISE TIME: (COLD: .550 SEC. TO 24.0 Vdc; HOT: .390 SEC. TO 24.0 Vdc)

