

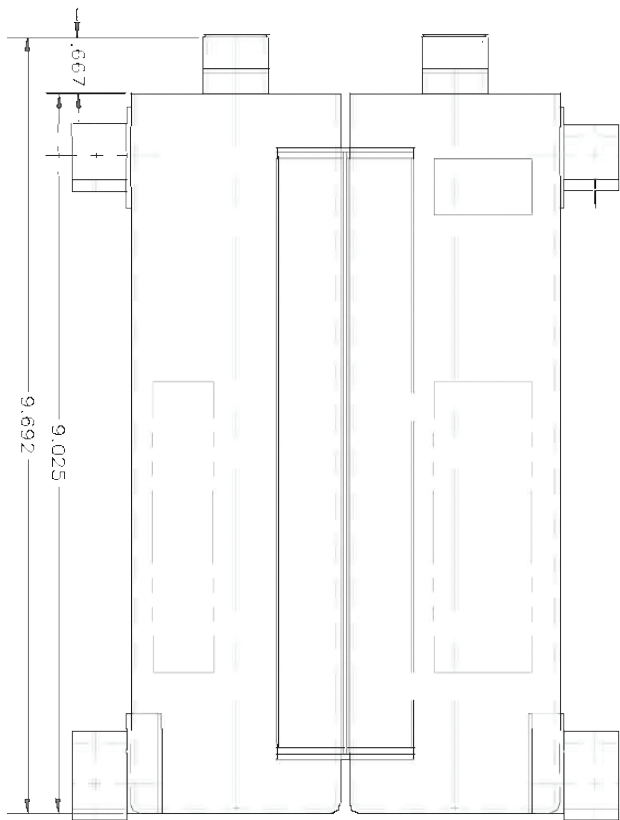

EAP-12216 Thermal Battery



Lithium Silicon/Iron Disulfide
Case and Header 304 Stainless Steel



Specifications	
Part Number	EAP-12216
Weight	5.3 g (11.8 lbs)
Nominal Volume	43.75 in ³
Dimensions	Width: 190 mm (7.5 in)
	Length: 246 mm (9.7 in)
Voltage	152 VDC section 157 VDC max with varying min 28 VDC section 35 VDC max; 23.5 Vdc min
Load	152 VDC: 0 A baseload with 0.2, 34, 1.8, 4, 10.8, 4.3, 22, 11.6, 22.5, 0.1, 0.9, 1.9, 13.3, 1.0, 3.4, 0.6, 34, 7.6, 1.2, 34, 6.2 A pulses From 0 s to 600 sec
	28 VDC: 0 A baseload with 7.1, 2.6, 0.1 A pulses from 6 to 36 sec, 50 pulses (10.1 A 75 ms) starting at 200 sec, repeating every 8 sec
Rise Time	0.8 sec
Life	600 sec
Activation	EP-250-1x
Activation Indicator	Temperature sensitive pain dot and thermostatic switch
Operating Temperature	-32° to 60°C (-25° to 140°F)
Acceleration	15.0 g for 10 min in X-axis
Vibration	13.4 g with a PSD spectrum of 0.09 g ² per Hz from 20 Hz to 2 KHz for 400 ms
Shock	Pulse of 5 g for 11 ms in X-axis
Altitude	Ascent to 248,000 ft above seal level and returning at a rate of 0.6 KPa/Sec while being subjected to 0.002 KPa
Acoustic	150 dB from 20 Hz to 20 KHz for 10 min
Terminal Material	Nickel iron alloy gold plated

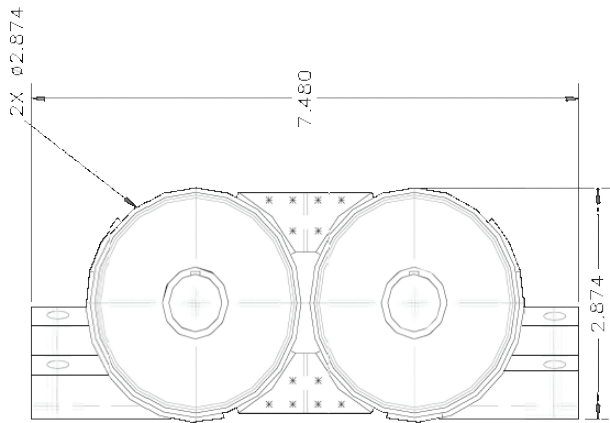

EAP-12216 Thermal Battery

